

TECHNICAL

V-DUO SERIES

V-DUO	V-60/60 Duo	V-90/90 Duo	V-130/130 Duo
Parts no. (*=Table model)	01 03 51* / 01 00 51	01 03 52* / 01 00 52	01 03 54* / 01 00 54
Ink residue pick-up system	integrated	integrated	integrated
Single cycle	yes	yes	yes
Multiple printing	yes	yes	yes
Continuous run	yes	yes	yes
Piece counter	yes	yes	yes
Variable speed control	yes	yes	yes
Cycles/hour	max. 1.200	1.200	800
Ink cup/doctoring cup	∅ mm 60	90	130
Variable doctoring contact pressure	yes	yes	yes
Cliché size	mm 70 x 140	100 x 215	150 x 300
Print image size max.	∅ mm 55	85	125
Variable tampon stroke onto workpiece	mm 10-160 optional: 0-200	10-160 optional: 0-200	10-160 optional: 10-200
Variable tampon stroke onto cliché	mm 10 - 130	10 - 130	10 - 100
Tampon installation height max.	mm 100	100	157
Force of pressure	N 1.170	1.170	2.500
Drive	electropneumatic	electropneumatic	electropneumatic
Connected load	kW 0,5	0,5	0,5
Power supply	230V/1/N/PE	230V/1/N/PE	230V/1/N/PE
Interface	D-SUB 37-pole	D-SUB 37-pole	D-SUB 37-pole
Power frequency	Hz 50-60	50-60	50-60
Control	PLC	PLC	PLC
Control voltage	V/DC 24	24	24
Prefuse	A 16	16	16
Pneumatic supply fine filter 5 µm	bar 6	6	6
Air consumption / cycle	NL 9	9	26
Width	mm 640	640	830
Depth	mm 820	820	1170
Height	mm *710 / 1.550	*710 / 1.550	*890 / 1.750
Weight	kg *160 / 280	*160 / 280	*400 / 550

Scope of supplies:

- Toolkit
- 1 assembly table
- 1 pair gripping tongs
- 2 ink/doctoring cups
- 2 thrust collars
- 1 spray bottle, 500 ml
- 2 tampon couplings
- 1 ink residue pick-up system
- Foot switch
- Documentation
- 2 tampons 410, 6 Shore-A, quality 3

Options:

- Rotary index table T2/T4 for mounting components and increasing the unit performance
- Rotary index table 150 T2/T4 for mounting components such as pre-processing and/or drying units
- N/C axes
- Table model upon request
- Cross table "small", "large", "AL"
- Thinner metering system
- x-y-assembly table
- Light curtain

Dealer:



TAMPOPRINT® AG
 Lingwiesenstraße 1
 70825 Korntal-Münchingen, GERMANY
 ☎ +49 7150 928-0
 Fax: +49 7150 928-400
 E-Mail: info@tampoprint.de
"Ventes et Affaires Françaises"
 ☎ +49 7150 928-144
 Fax: +49 7150 928-432
 E-Mail: ventes@tampoprint.de
 http: www.tampoprint.de

TAMPOPRINT® INTERNATIONAL CORP.
 1400 26th Street, Vero Beach, FL 32960, USA
 ☎ +1 772 778-8896, 800 810-8896
 Fax: +1 772 778-8289
 E-Mail: sales@tampoprint.com
 http: www.tampoprint.com

TAMPOPRINT® IBERIA S.A.U.
 c/Caspe 127-135 local B, 08013 Barcelona, SPAIN
 ☎ +34 93 2327161
 Fax: +34 93 2471500
 E-Mail: tampoprint@tampoprint.es
 http: www.tampoprint.es



The reproduction of trademarks and brands used in this brochure, even if not explicitly expressed, does not justify the assumption that such names or symbols may be considered as free as defined by the Trademark Act and may therefore freely be used. The rights are the property of the respective owner.

TAMPOPRINT® products are permanently updated to keep pace with the latest technological developments. For this reason, figures and descriptions are non-binding. Manufactured according to EC Directive 98/37/EC.

Subject to alterations! ©Copyright

V-DUO

TAMPON PRINTING MACHINES

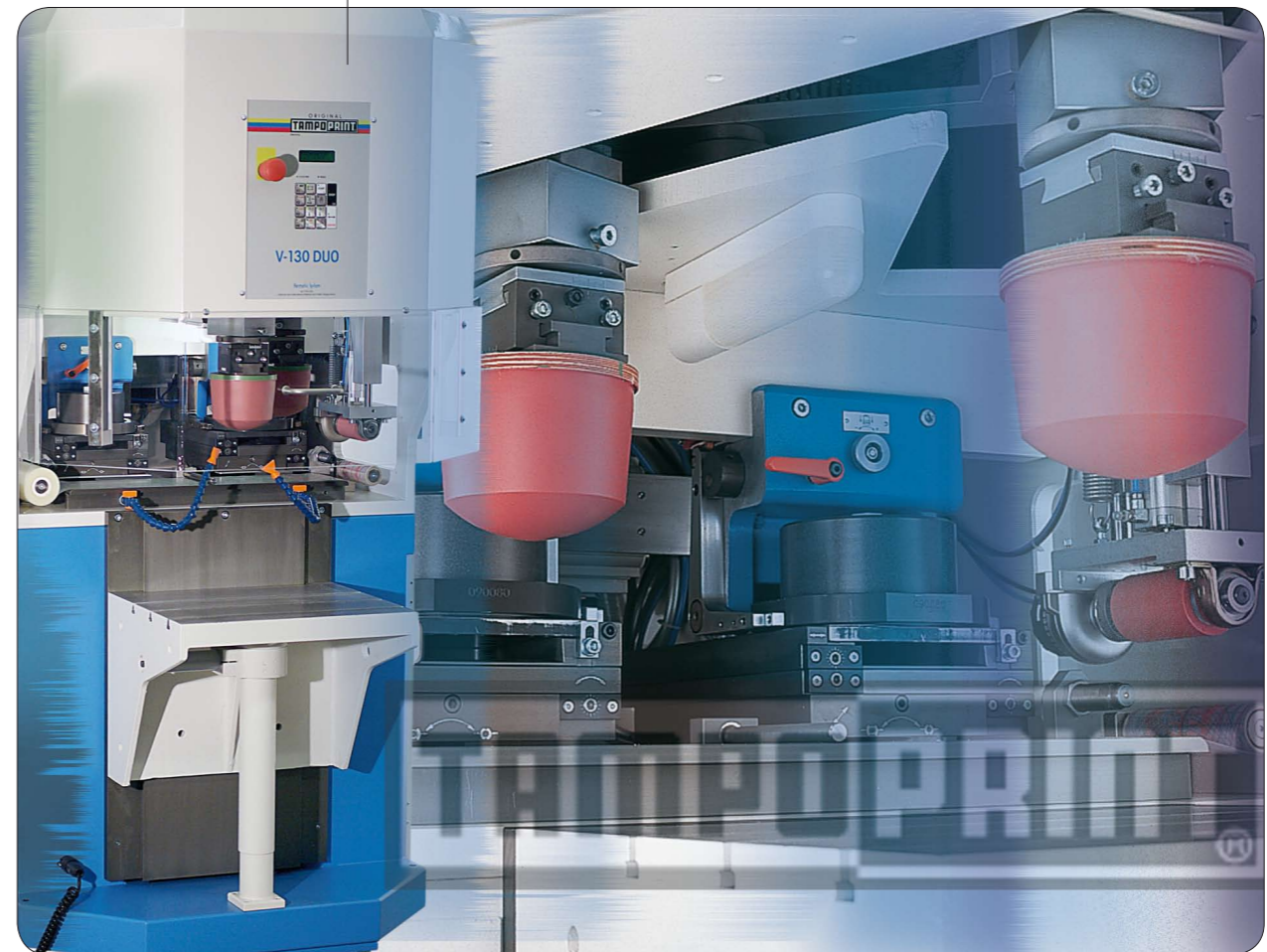

TAMPOPRINT
 ACCESSORIES
 SERVICE

2 Ink/doctoring cups are included

*technologies for your future
 made in germany*

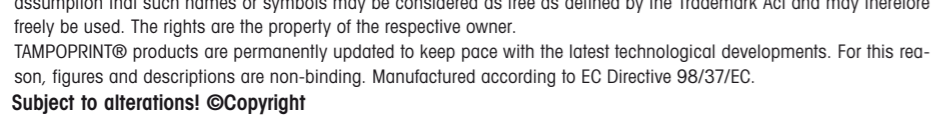

Tampon printing machines
 ALFALAS® Laser Systems
 Automations
 DMD® Industrial Inkjet Systems



V-60/90 DUO Standard tampon printing machine

V-60/90 DUO Increased performance with index table



With options & variations for a semi-automatic machine

Many options extend the application field of the V-DUO series.

- ✓ Control of an automation component takes place via the function "band conveyor start" (e.g. 2 different printing positions)
- ✓ The combination of only **one** "V-DUO" and our "multi-colour thrust collar" (2 ink/docting cups per cliché unit) makes it possible to print a four-colour image.
- ✓ For an increased performance we recommend to add an index table "T2", "T4" or "T150" with PLC control for mounting components.
- ✓ With the implementation of our standardised "Modul 1000" or "Modul 2000" the extension for a semi-automation will take place.



Machine concept worldwide exclusive at TAMPOPRINT® AG



V-60/90 DUO Increased performance by mounting the machine to a Modul 1000 unit & perfectly combined with flexible laser marking by means of Nd:YAG laser component.

2 Ink/docting cups are included

The „V-DUO“ series features special standard tampon printing machines.

The unique functional principle allows:

- ✓ the printing of both tampons at one printing position
- ✓ each printing unit can be programmed independently
- ✓ very high registration accuracy of print image and print position thanks to cliché holder with x-y-w adjustment
- ✓ 2-colour print images
- ✓ 2 different motifs
- ✓ setting options can be saved in 5 programme sequences and can be extended upon request
- ✓ synchronous print image delivery and print image pick-up thanks to V-shaped tampon bridge
- ✓ universal control leaves almost nothing to be desired
- ✓ ink residue pick-up system included



V-DUO with light curtain for your safety



V-DUO with ink residue pick-up system (included)



V-DUO & laser engraving & index table



V-130 DUO Increased performance by mounting the machine to a Modul 2000 unit.



V-DUO with printing component on x-y cross table (option)

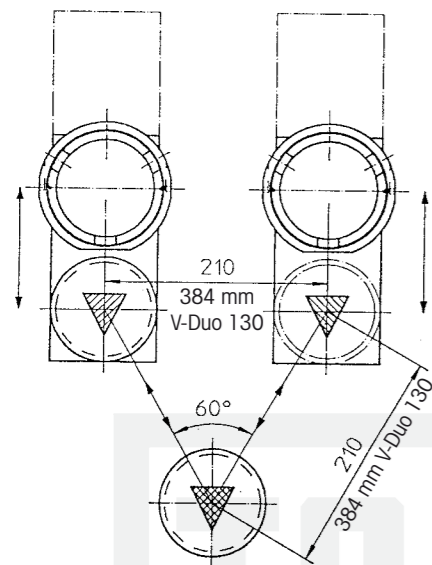

V-shaped arrangement of the 2 printing units



right tampon in the front prints, left tampon in the rear



left tampon in the front prints, right tampon in the rear